

HOBART

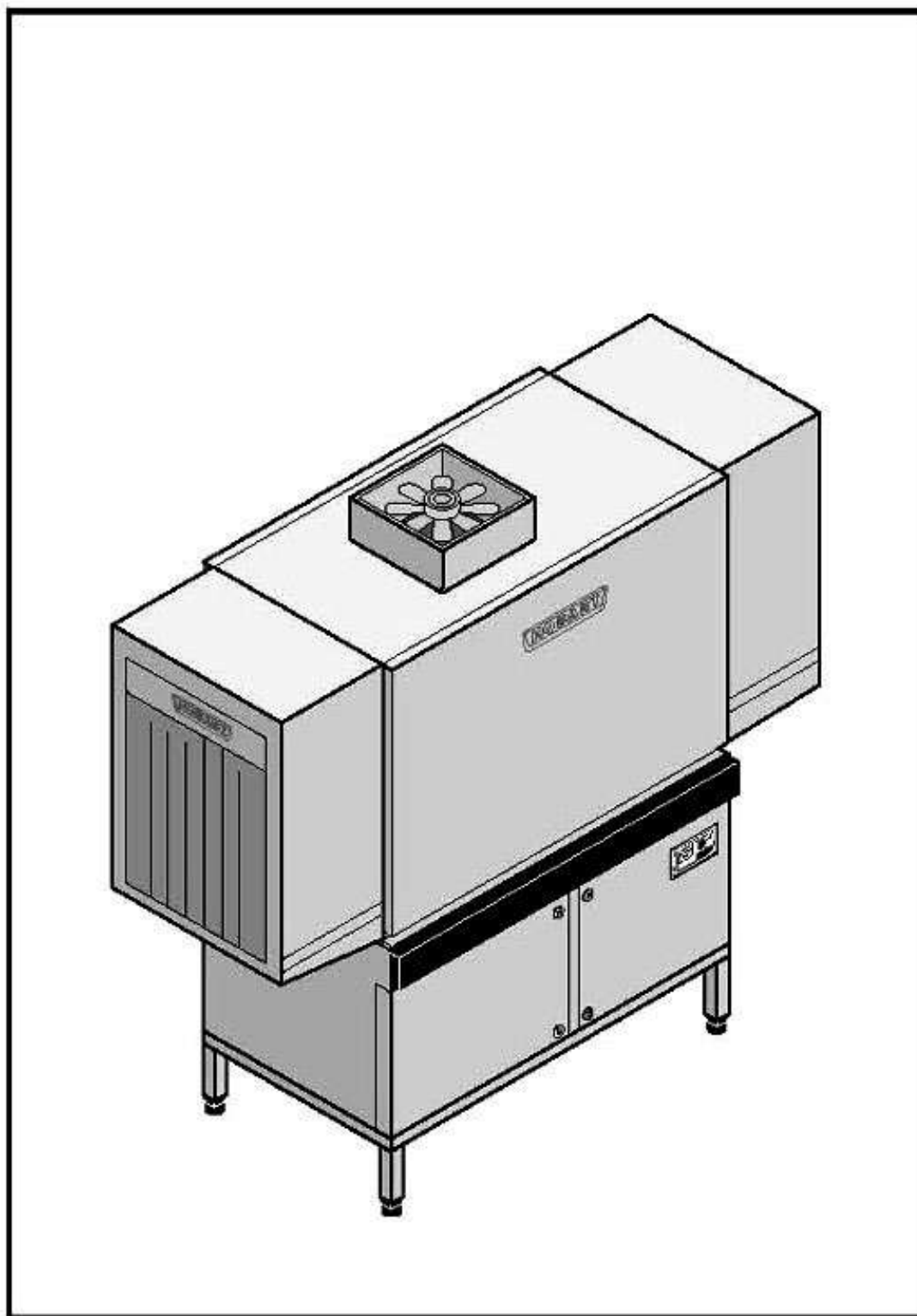

UCA

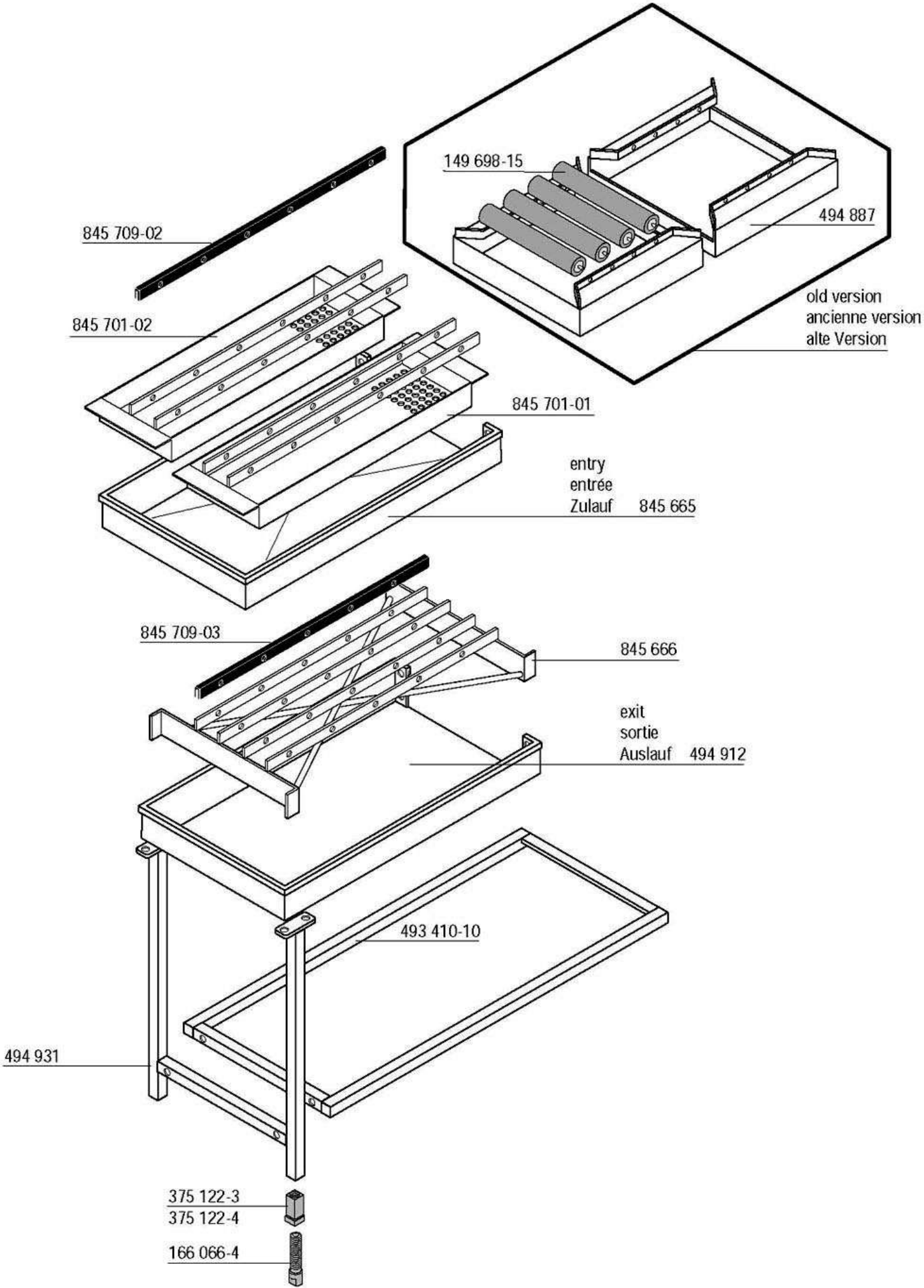

entry	R/L	494 666-02
exit	R/L	494 666-01
entrée	D/G	494 666-02
sortie	D/G	494 666-01
Zulauf	R/L	494 666-02
Auslauf	R/L	494 666-01
entry	L/R	494 812-02
exit	L/R	494 812-01
entrée	G/D	494 812-02
sortie	G/D	494 812-01
Zulauf	L/R	494 812-02
Auslauf	L/R	494 812-01

494 690-03	(L/R) (G/D)
494 690-02	(R/L) (D/G)
entry	
entrée	
Zulauf	495 030
exit	495 030
sortie	
Auslauf	

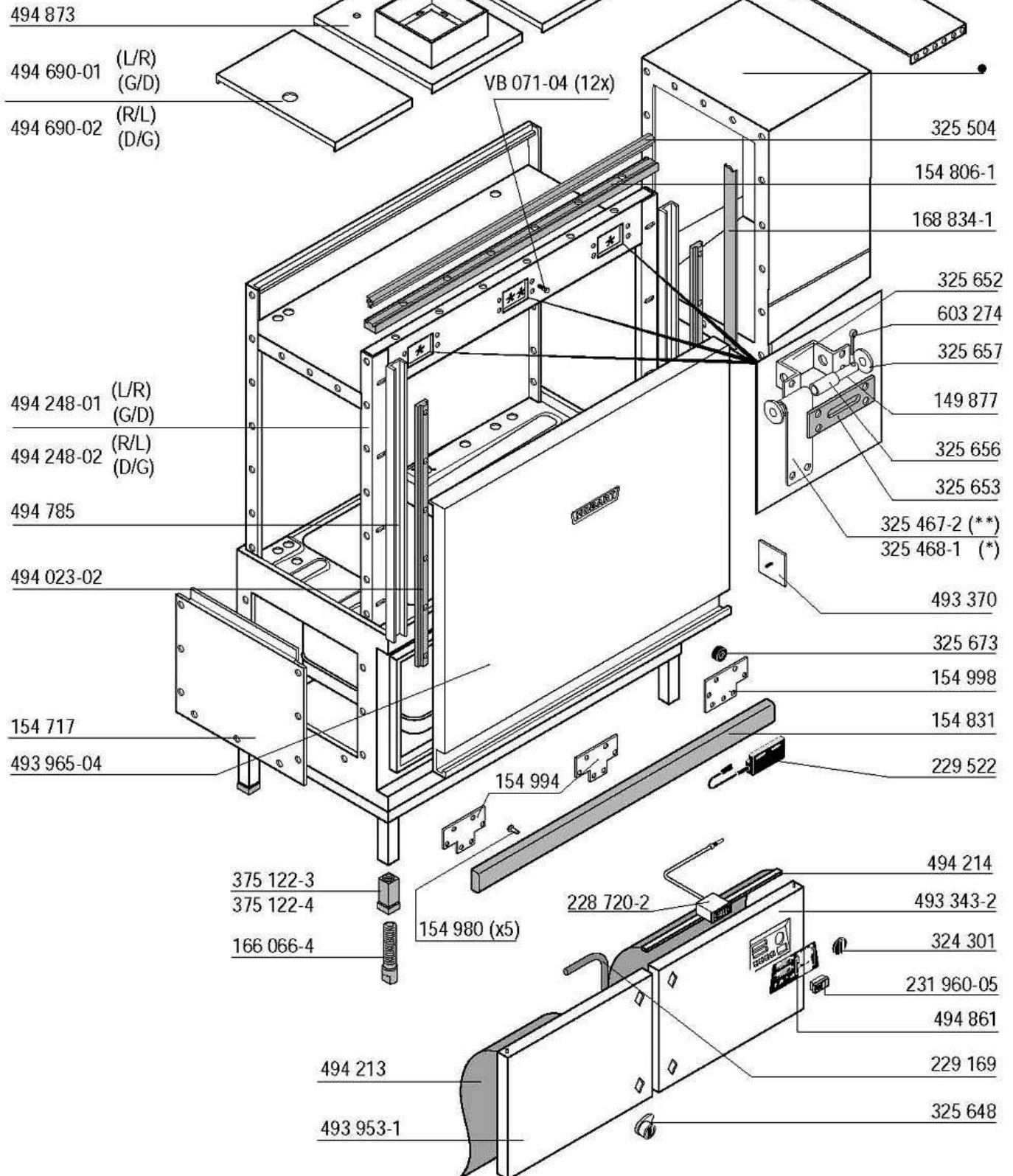

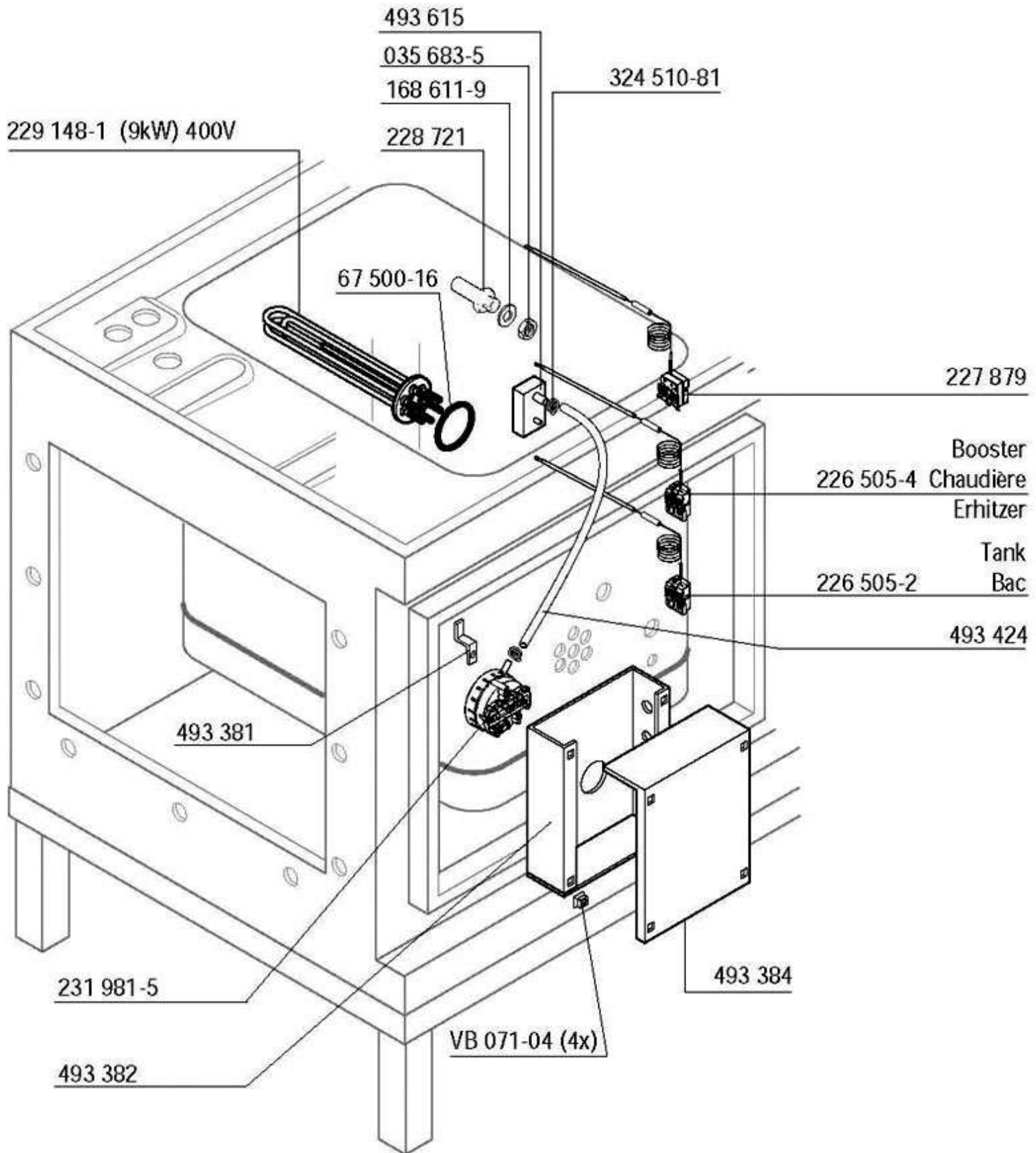

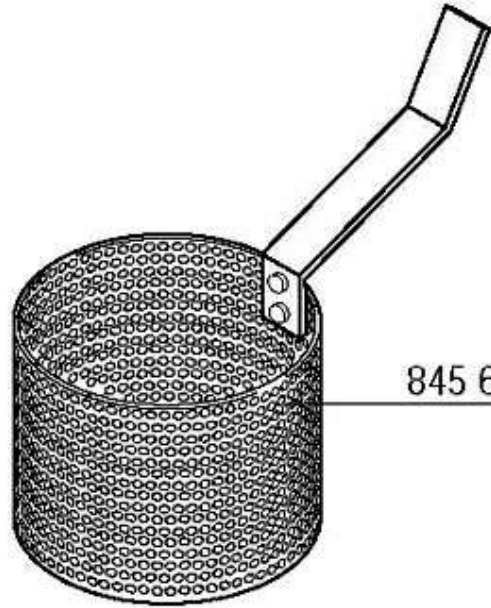

845 681

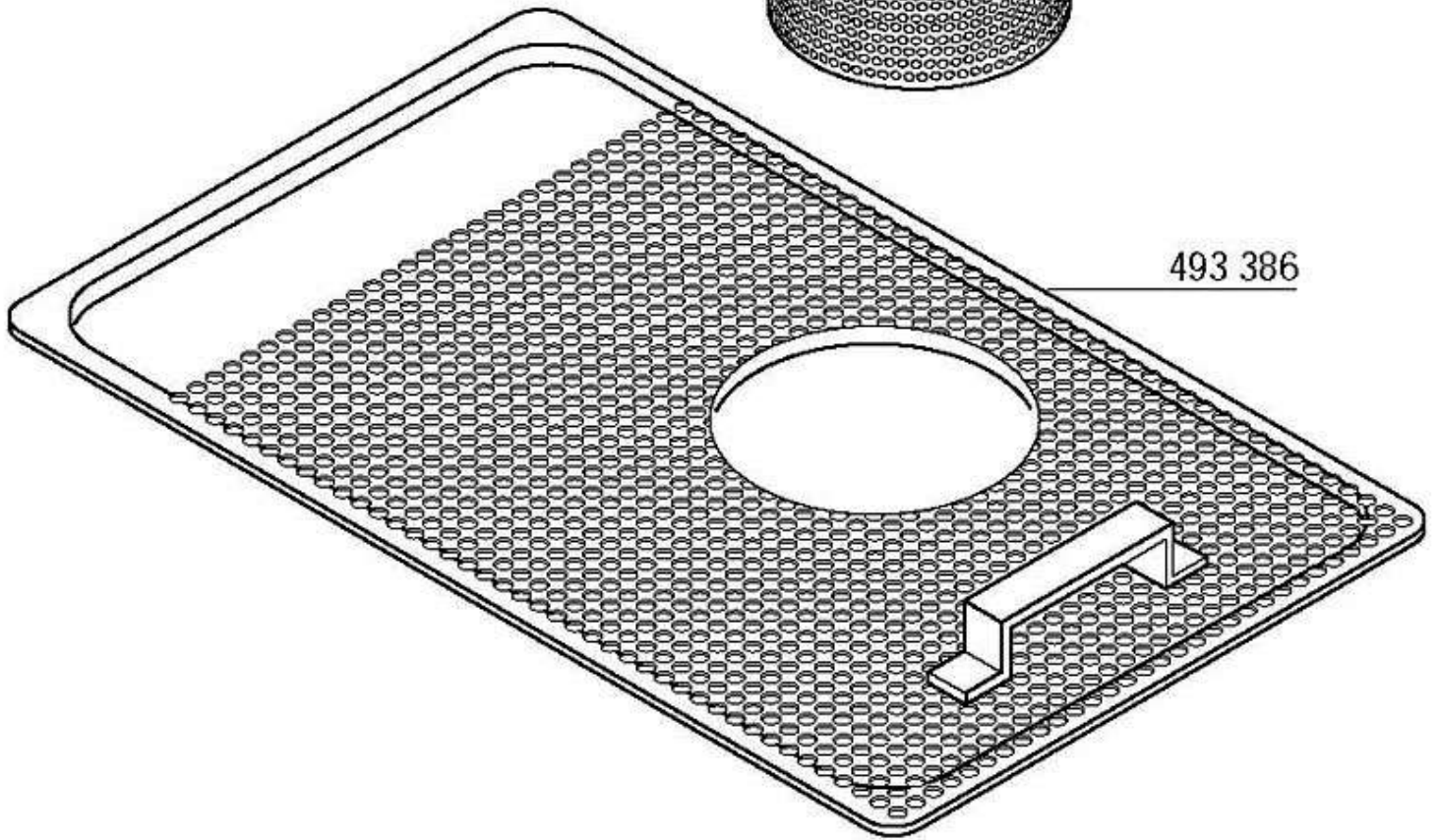

493 386



325 710-1

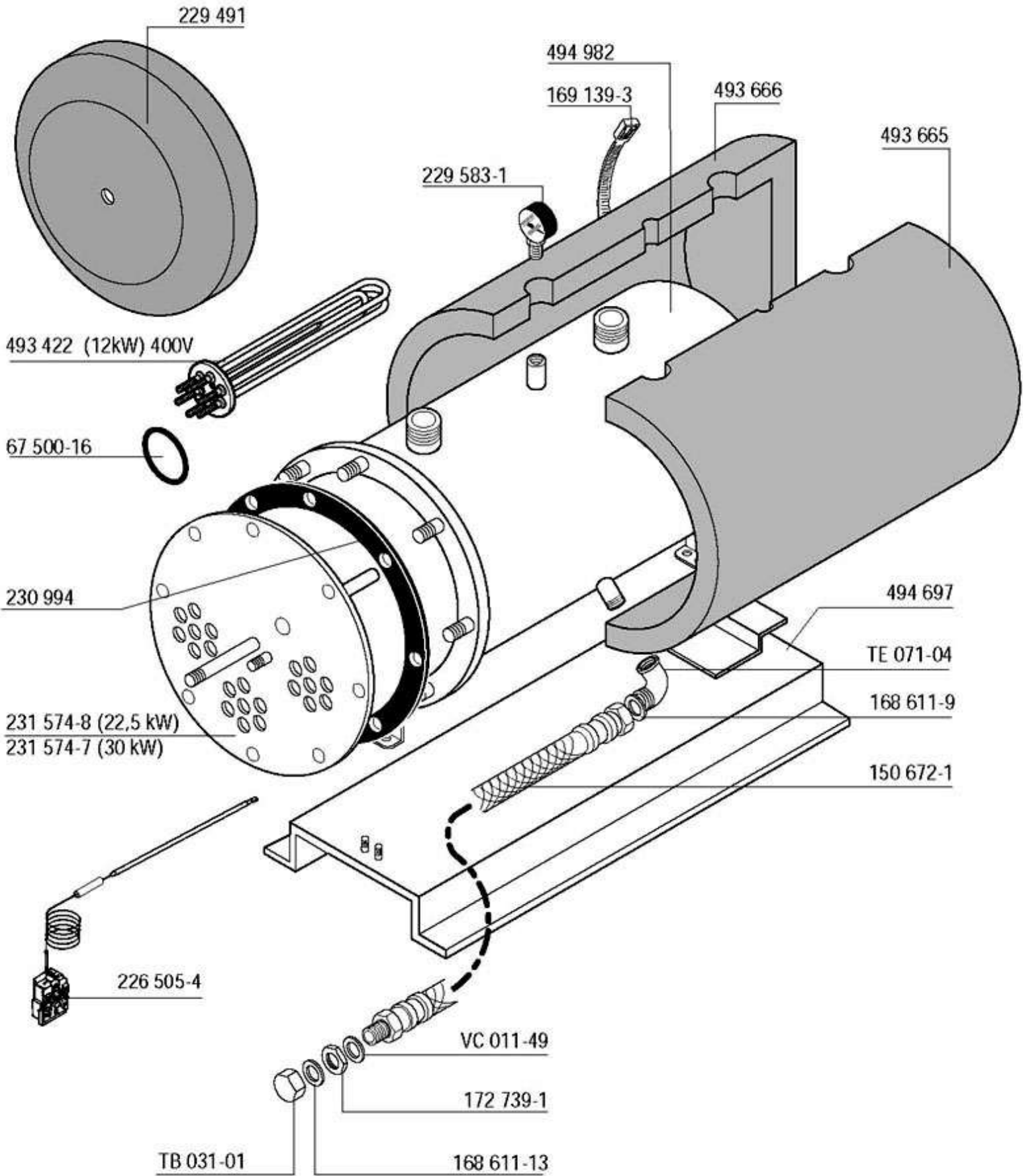

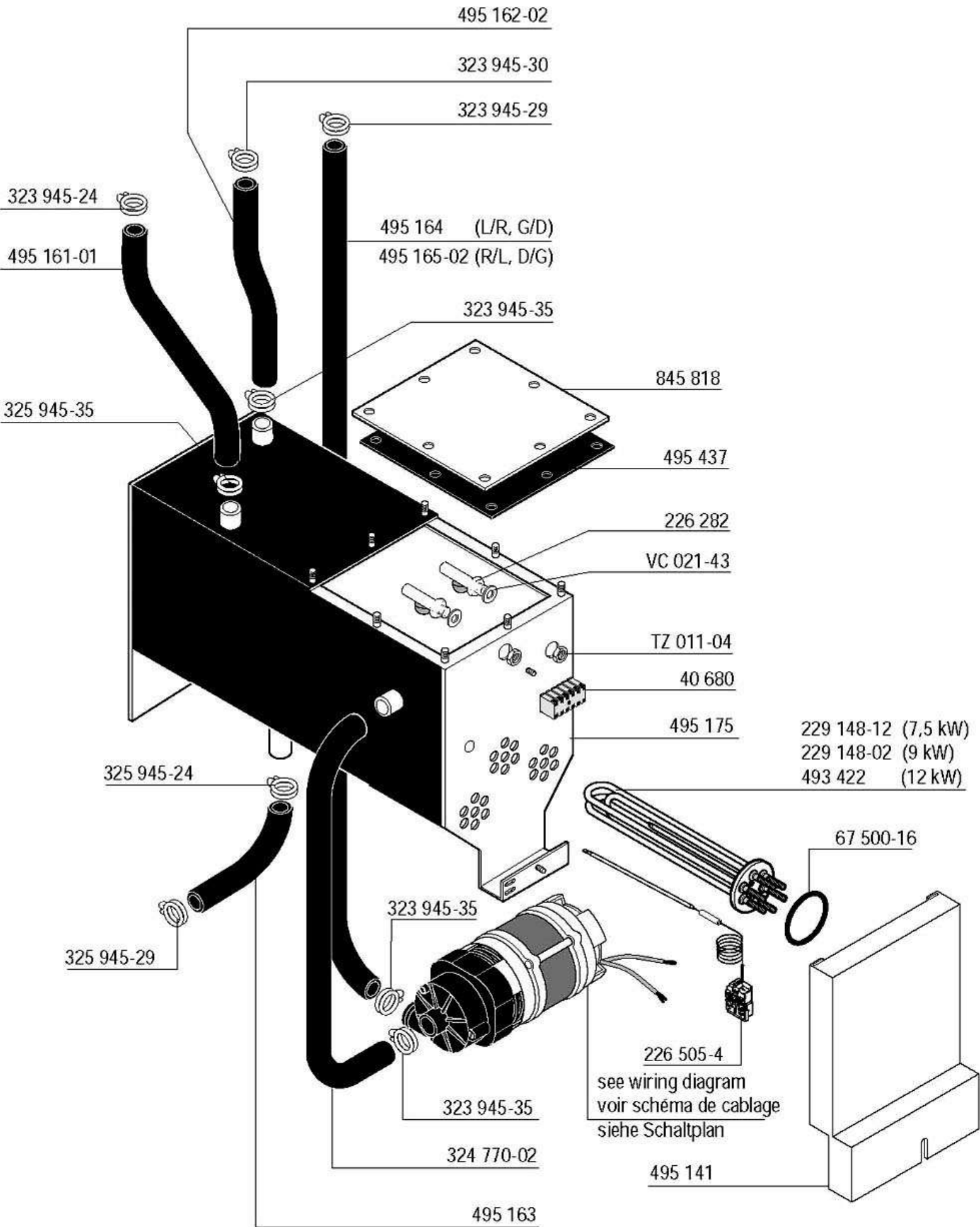

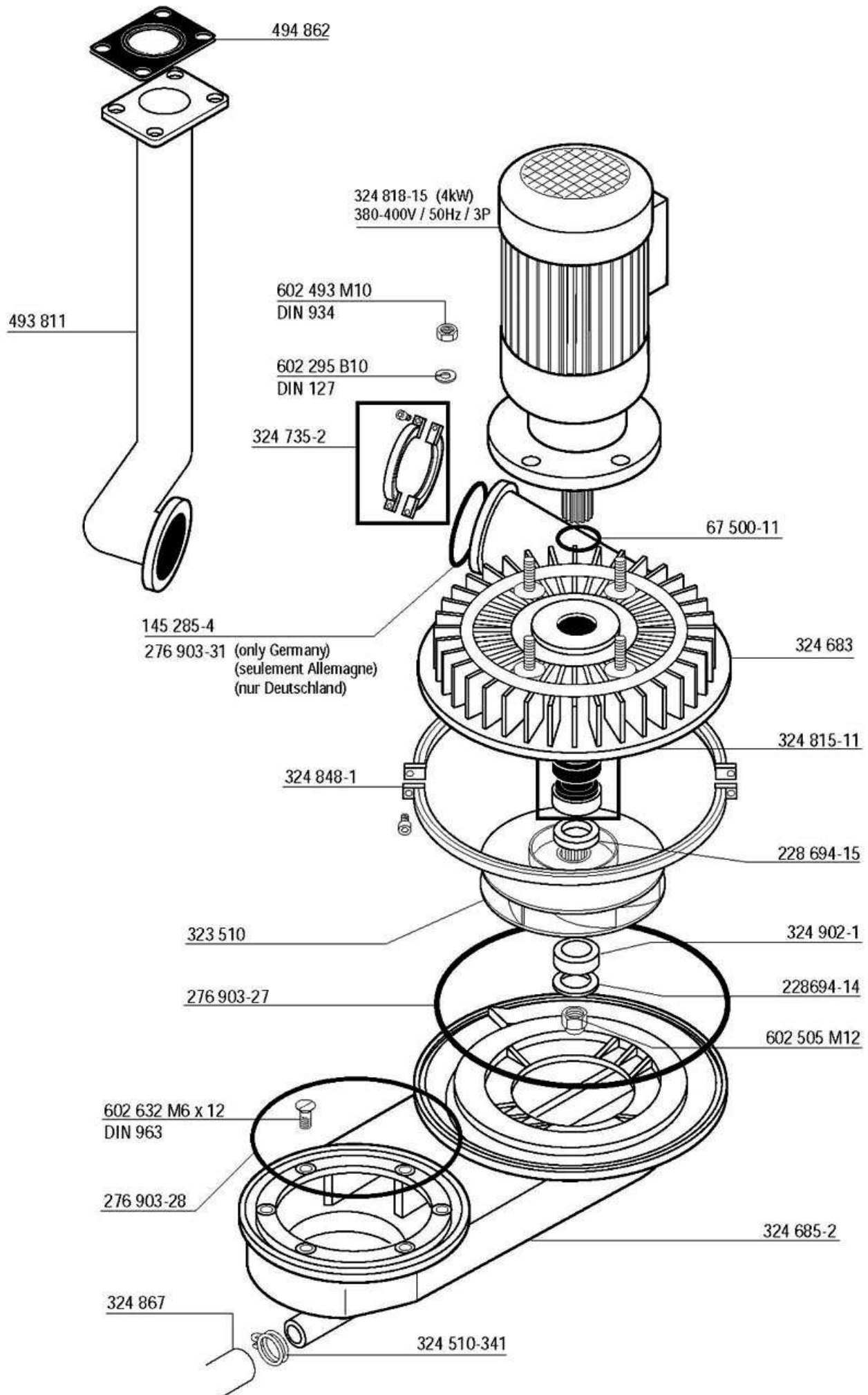

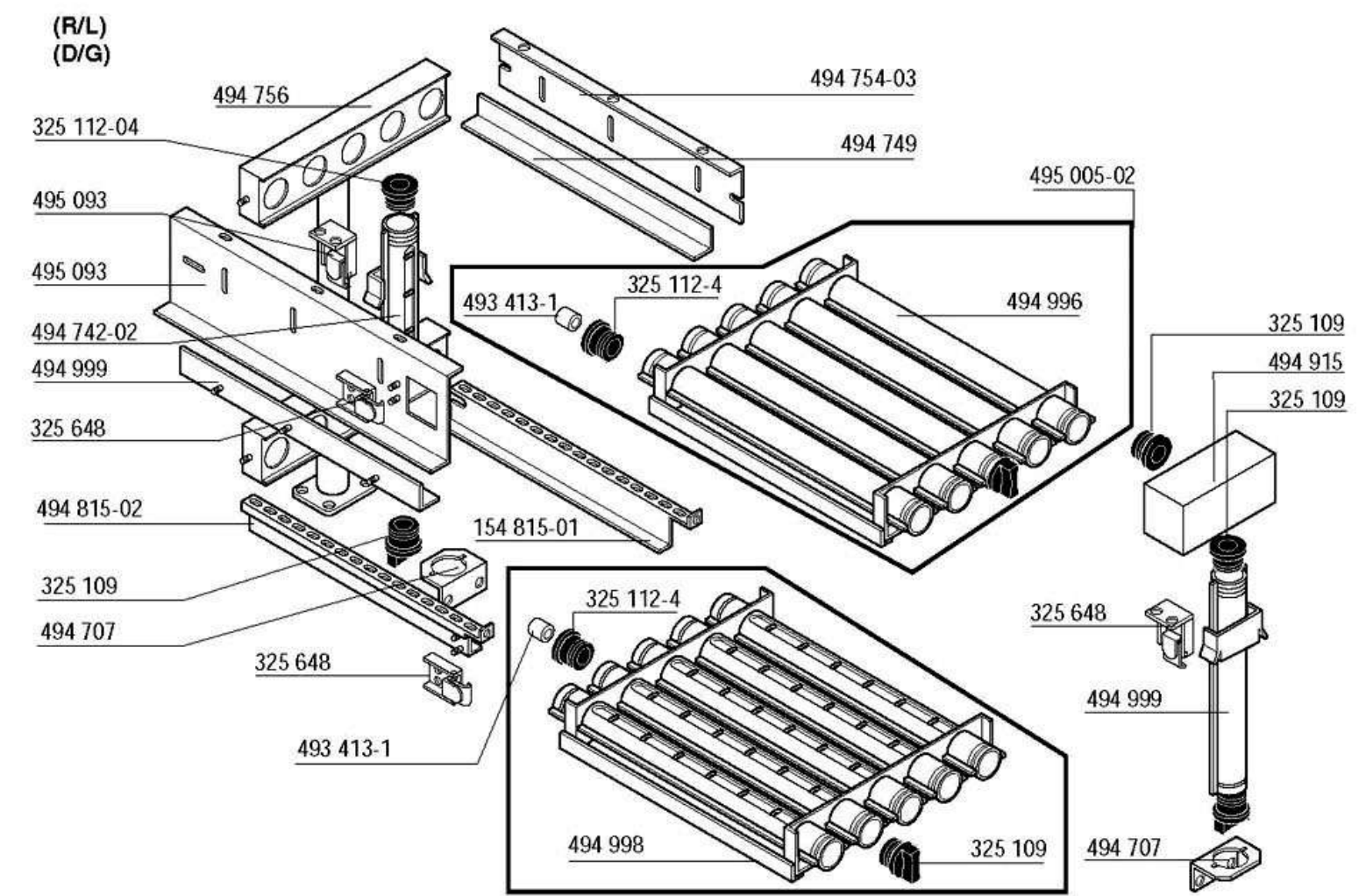
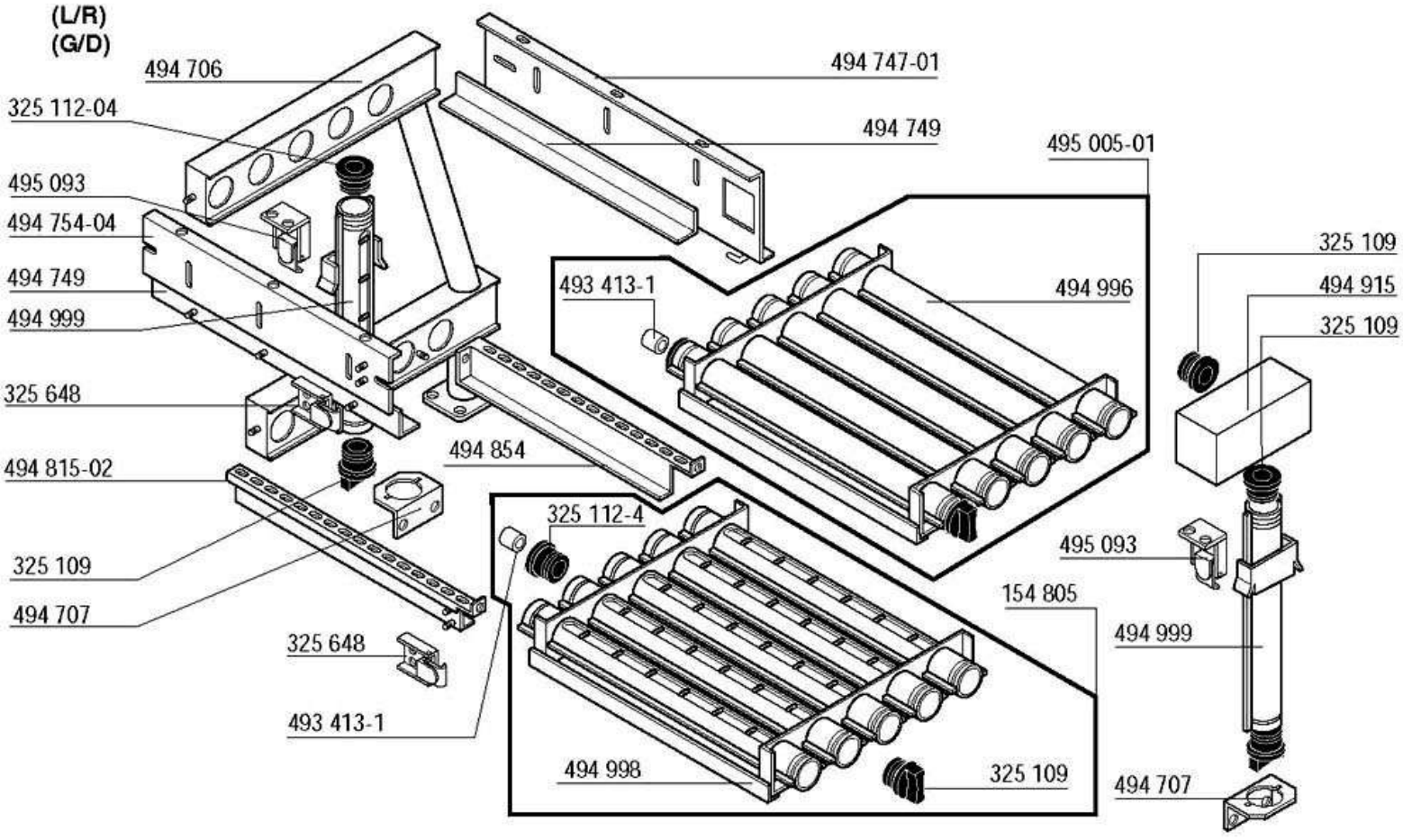

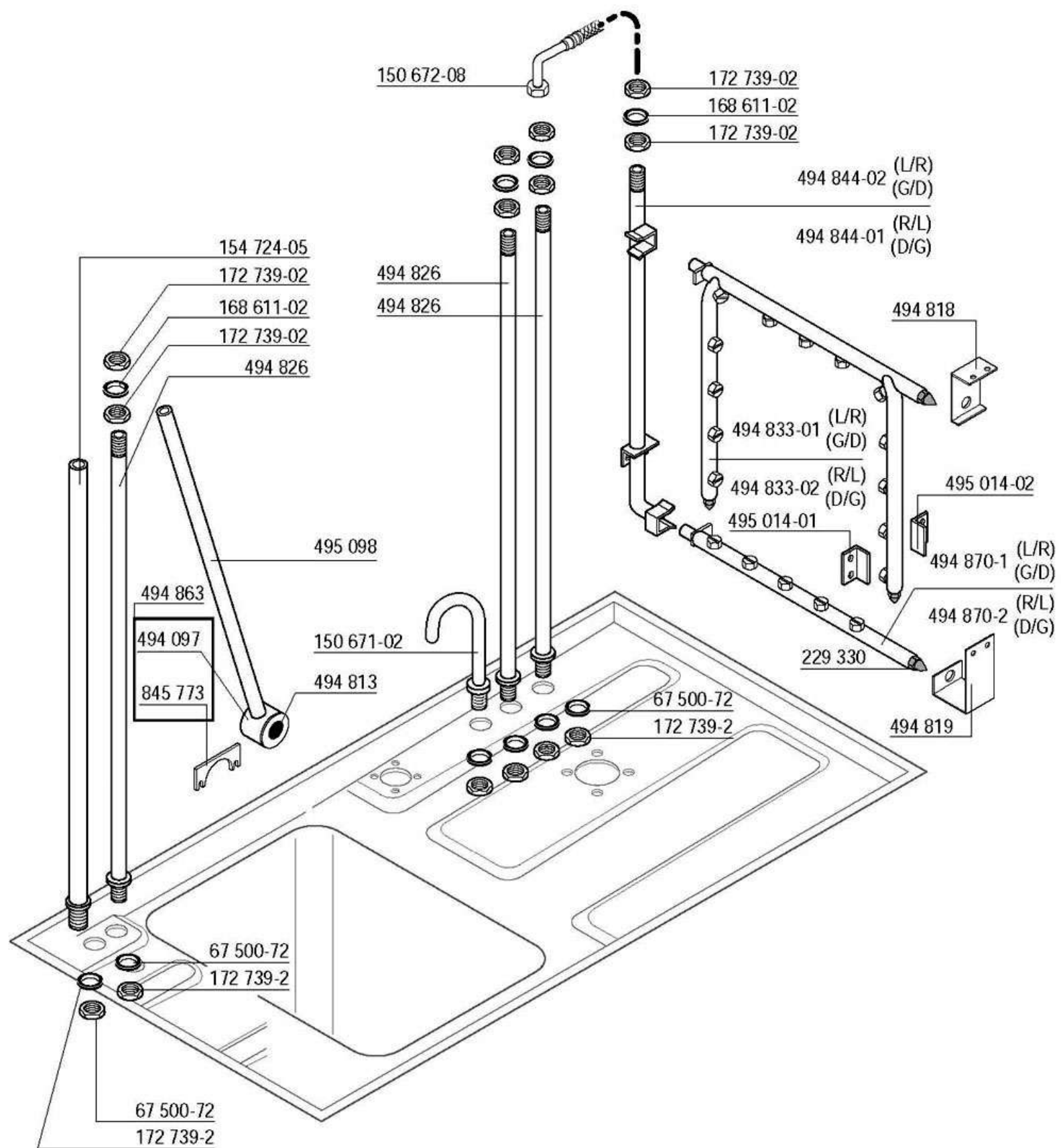

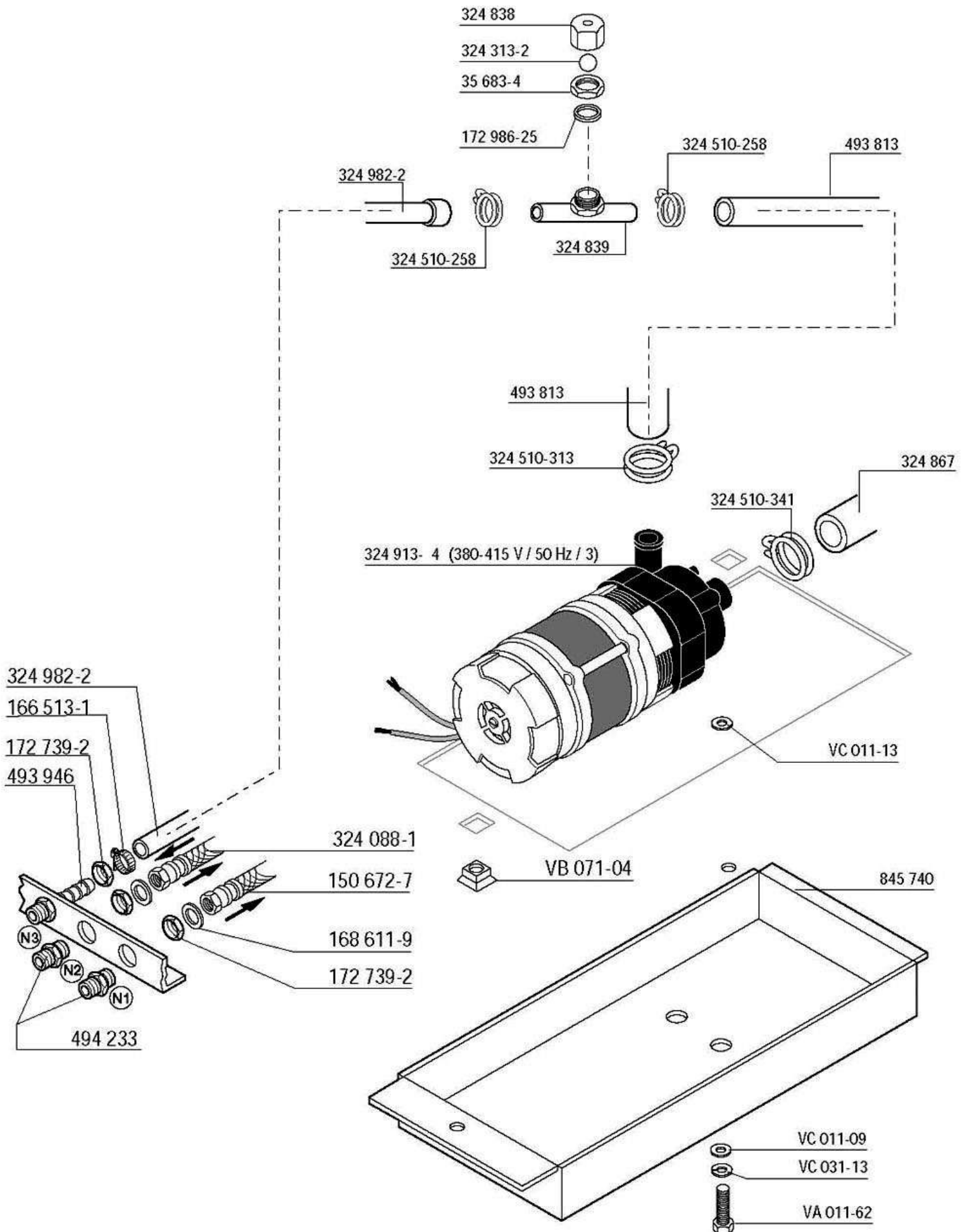

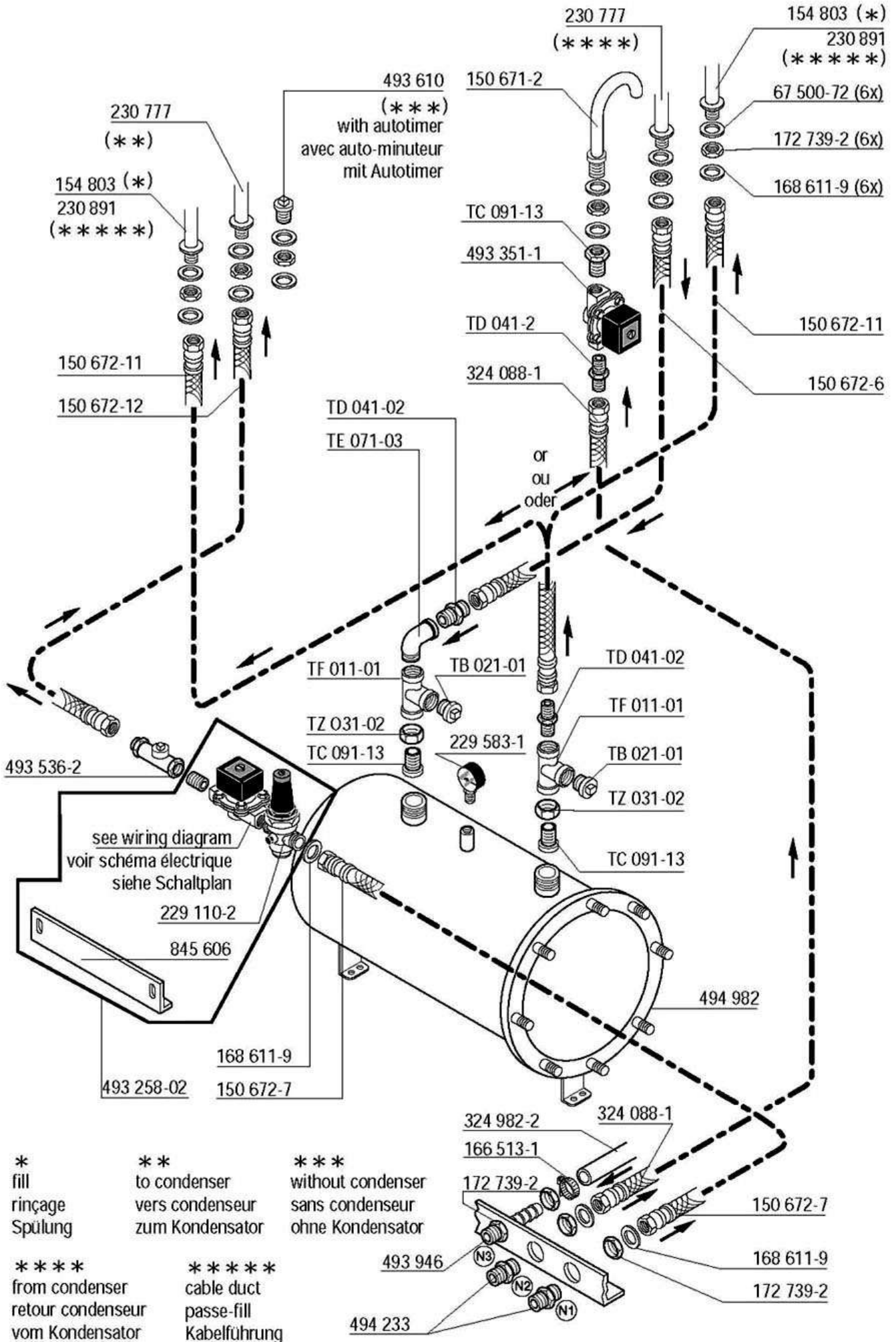

* fill
rinçage
Spülung

** to condenser
vers condenseur
zum Kondensator

*** without condenser
sans condenseur
ohne Kondensator

**** from condenser
retour condenseur
vom Kondensator

**** cable duct
passe-fill
Kabelführung

493 946
N3
N2
N1

494 233

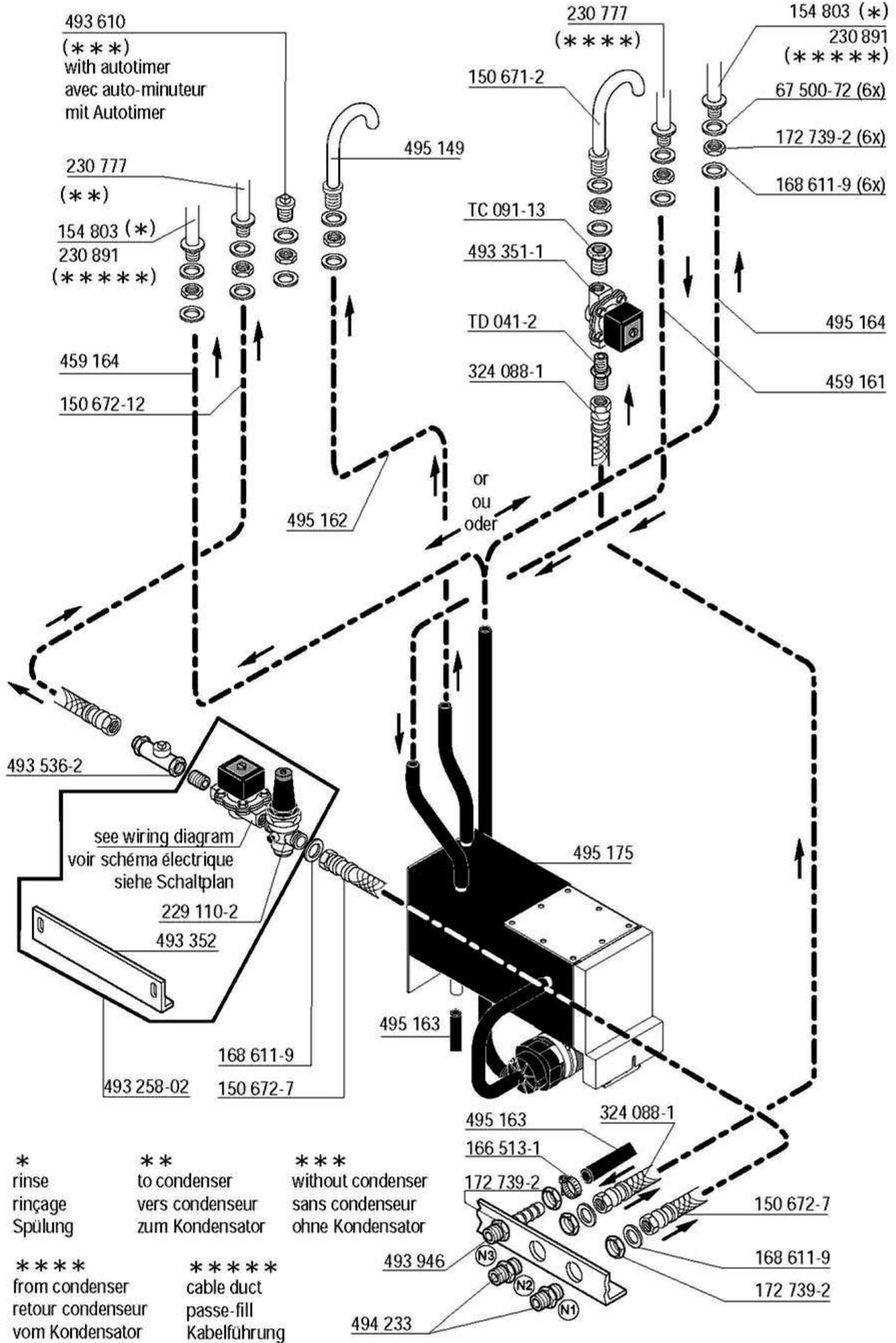

*
rinse
rinçage
Spülung

**
to condenser
vers condenseur
zum Kondensator

without condenser
sans condenseur
ohne Kondensator

from condenser
retour condenseur
vom Kondensator

cable duct
passe-fill
Kabelführung

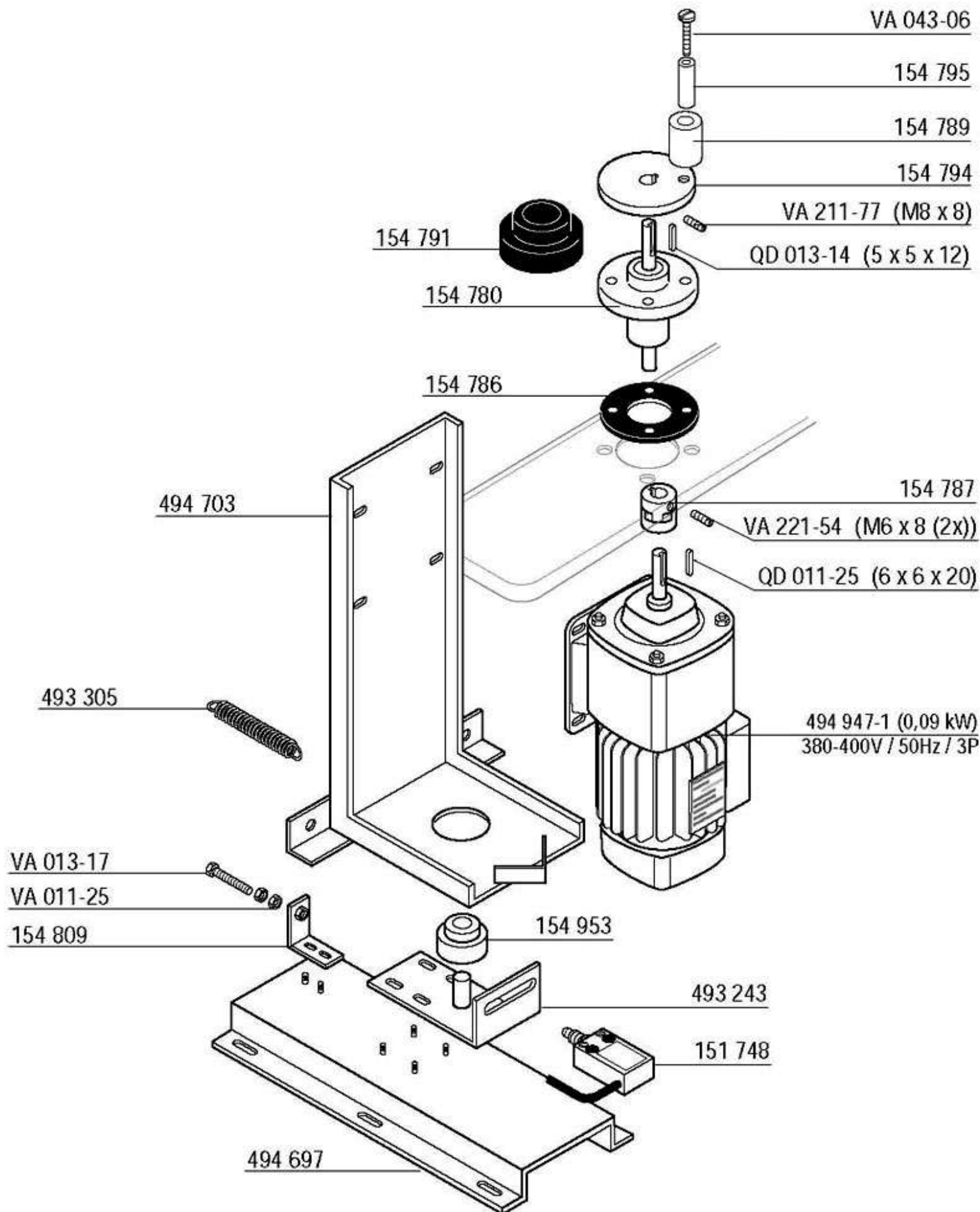

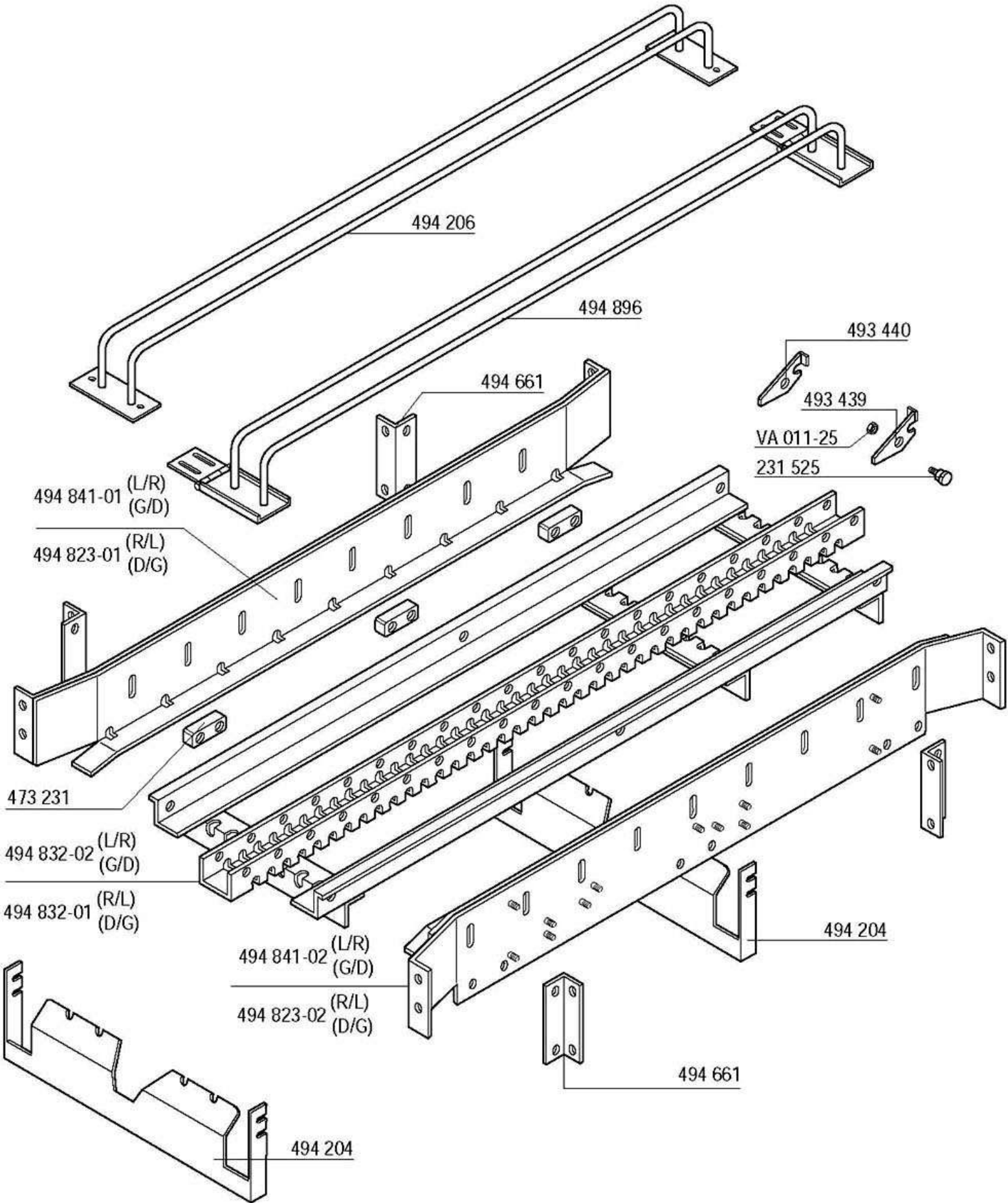

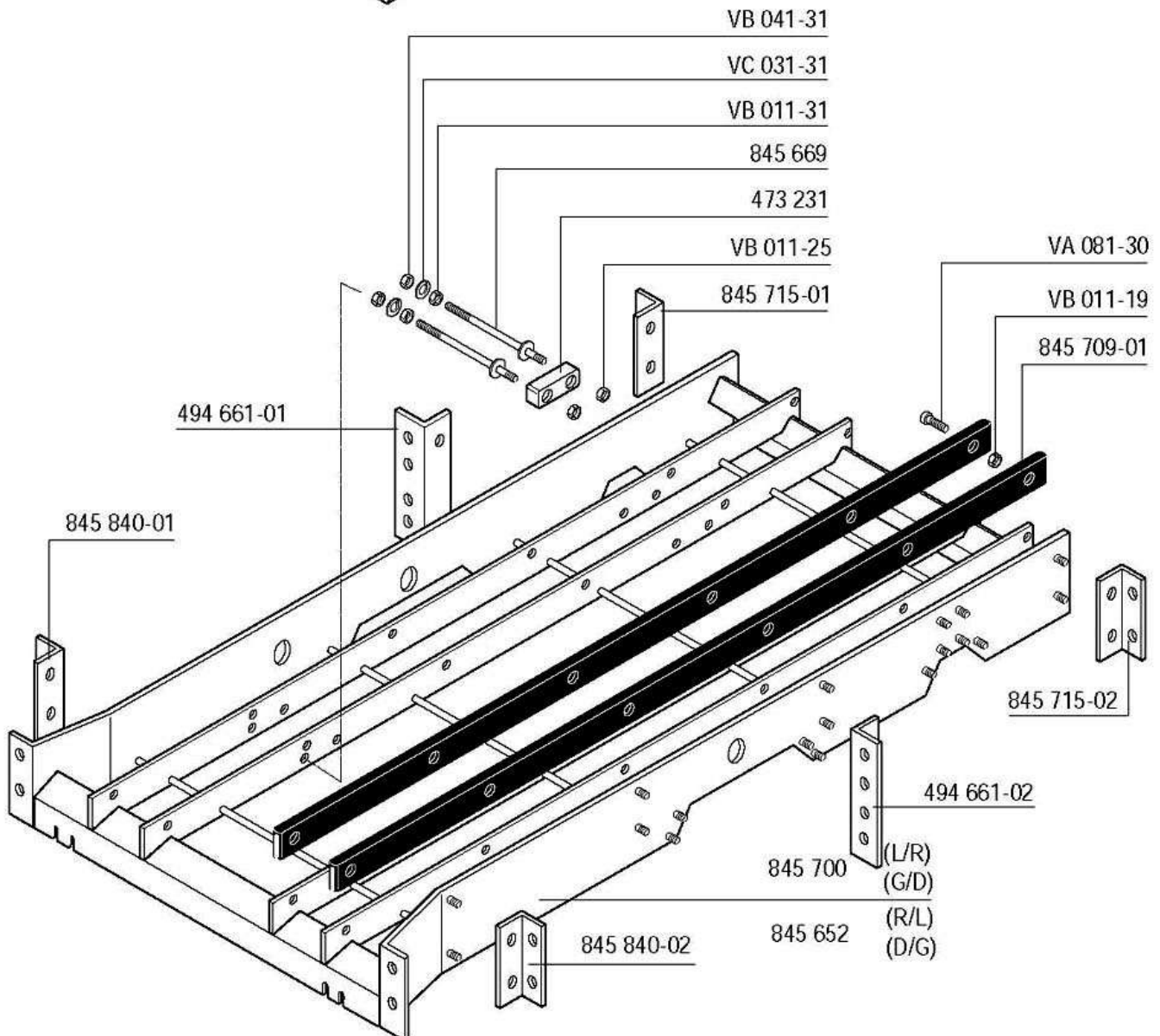
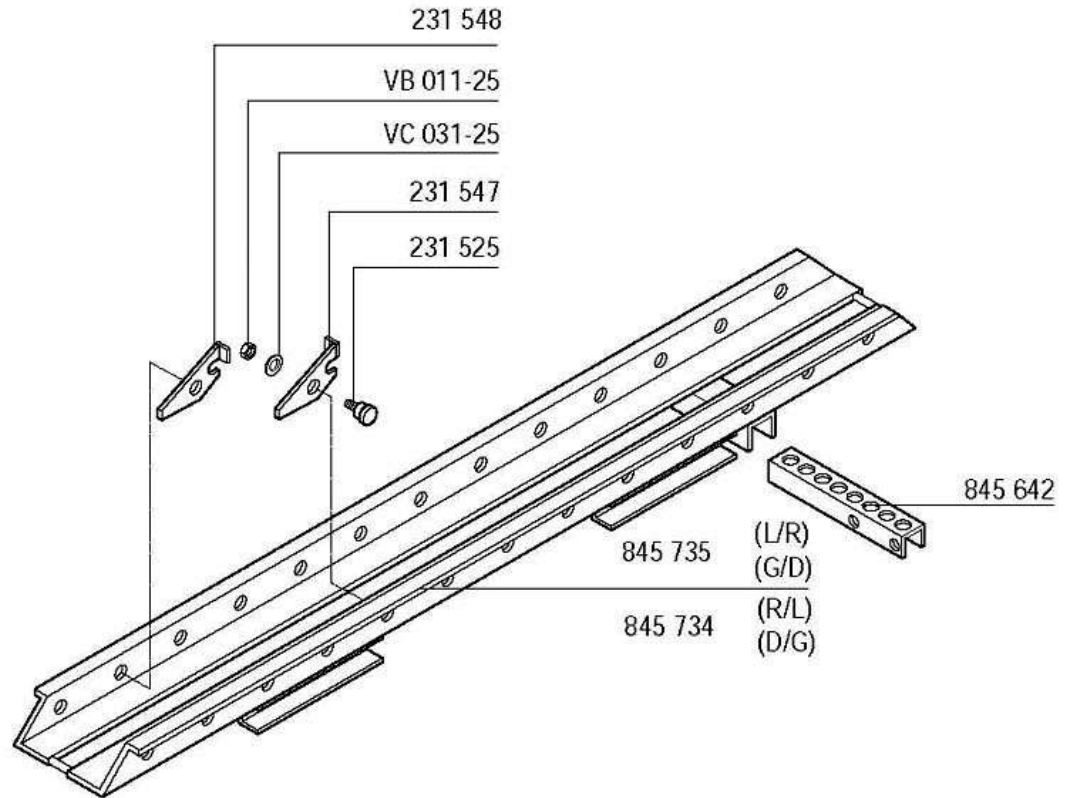

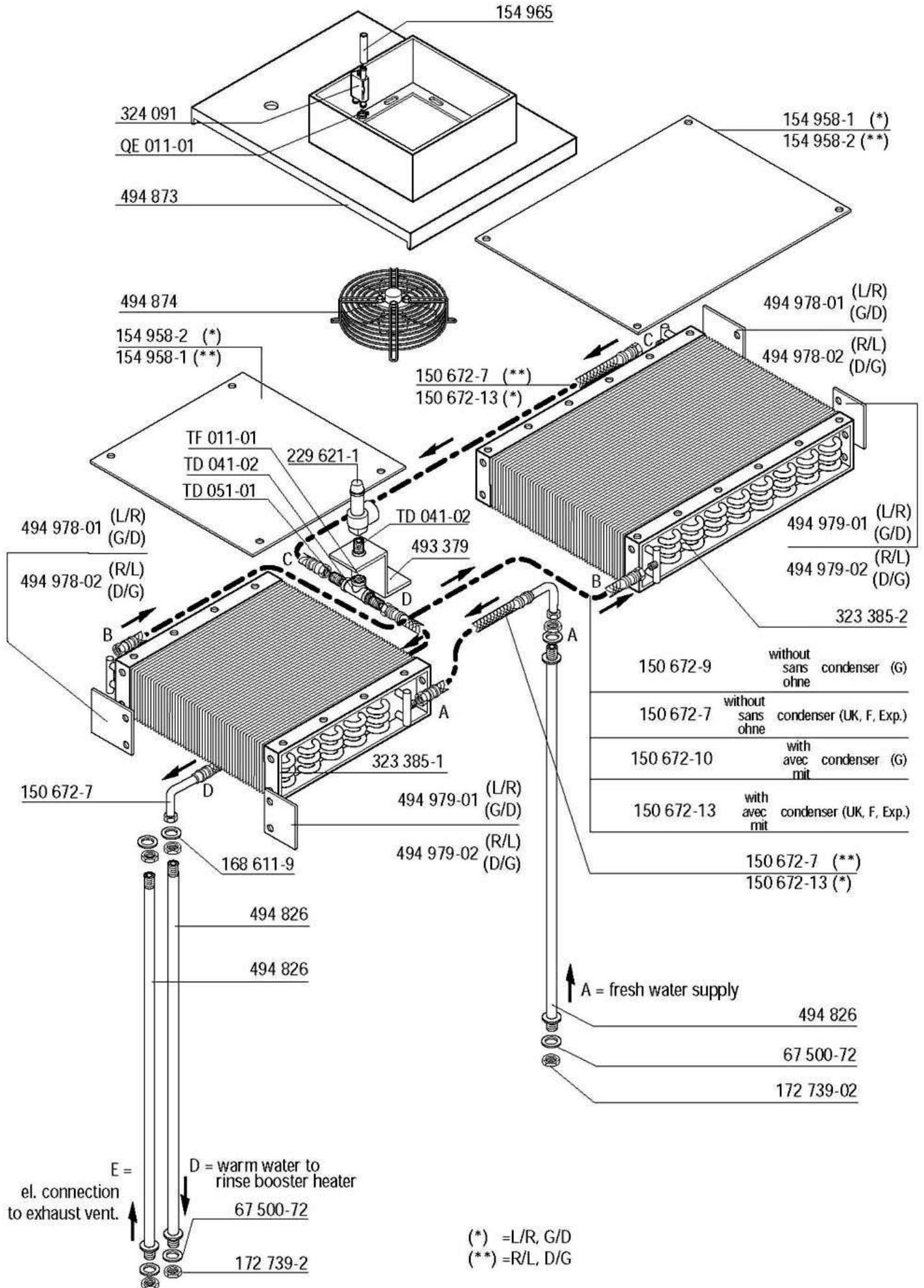

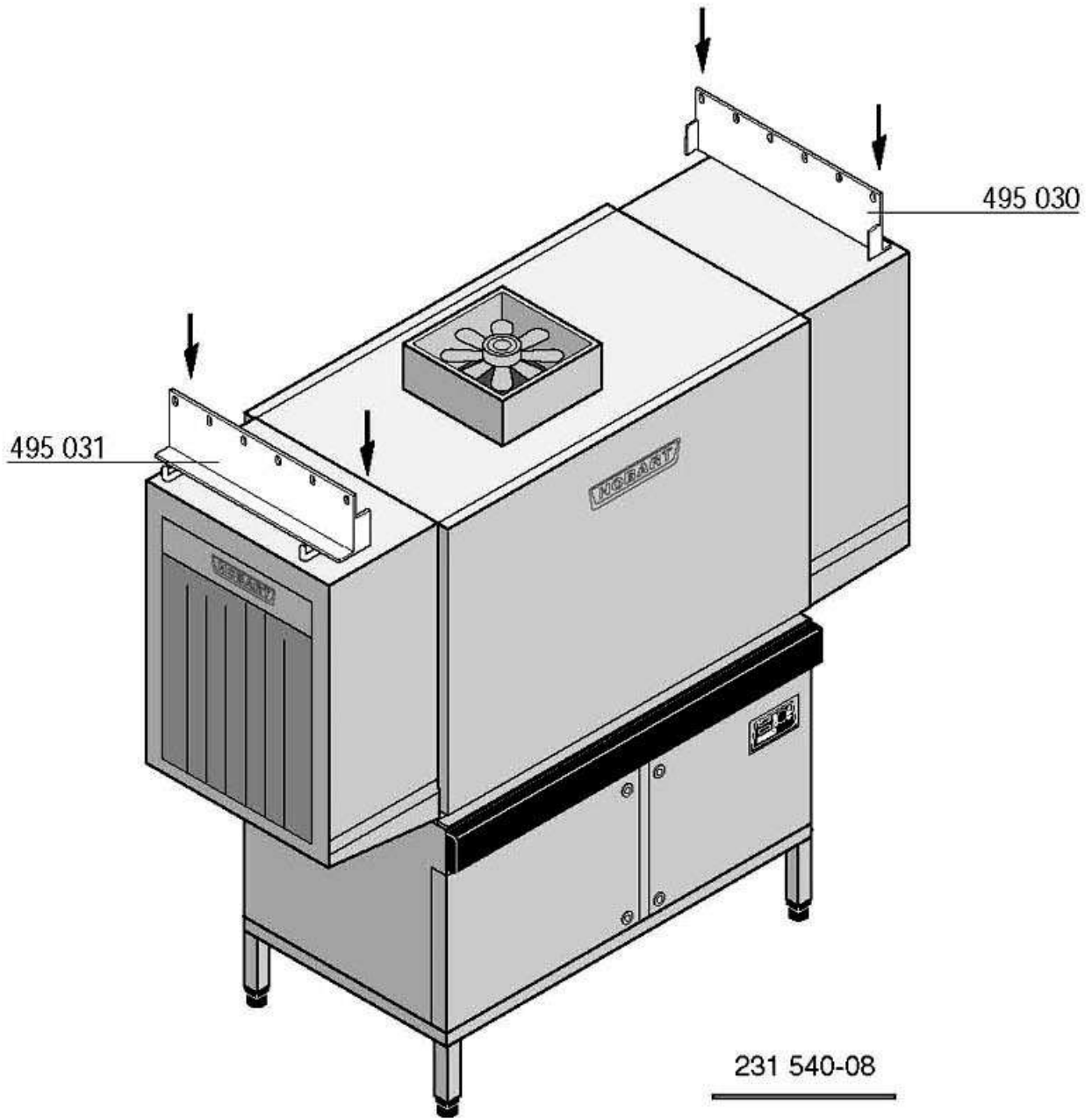

494 827

